

# Manual

## Smart 4 Outlet Powerboard with 2 x USB

(CSH-4PWB2USB / LSH-4PWB2USB)

### 1 GET THE APP



QR Codes for  
Downloading Apps

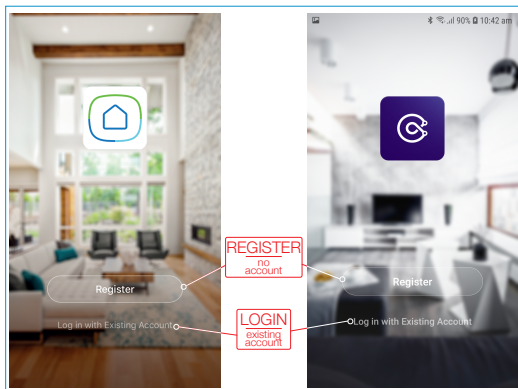
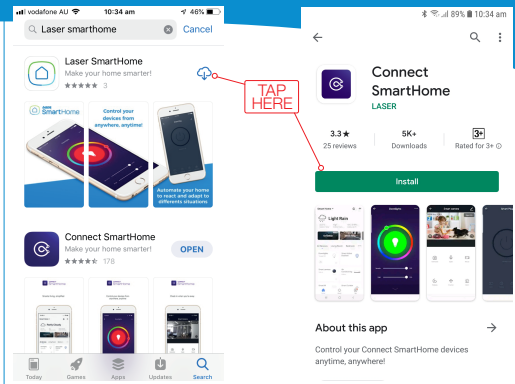

### 2 REGISTER OR LOGIN TO APP

### 3 RECOMMENDED APP SETTINGS

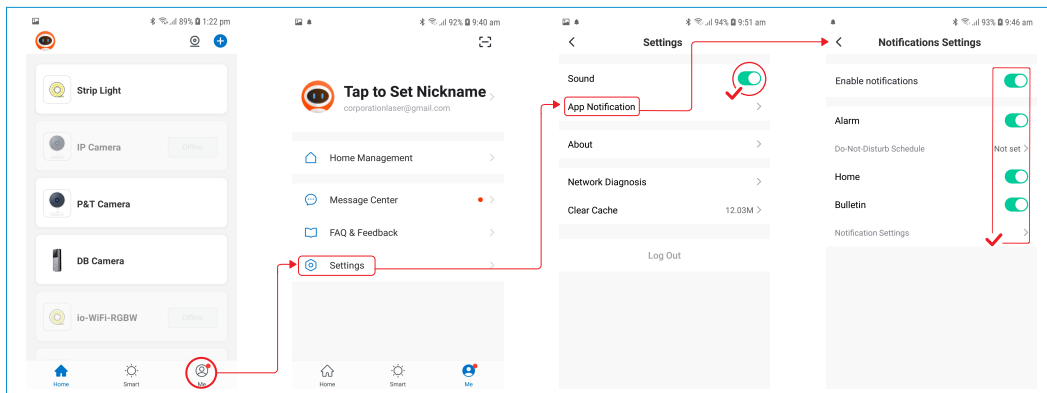

# 4 | CONNECTING POWERBOARD TO APP

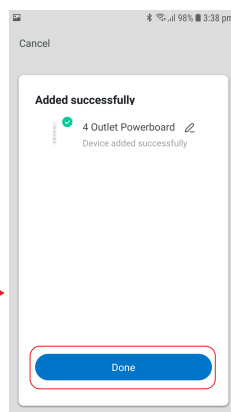
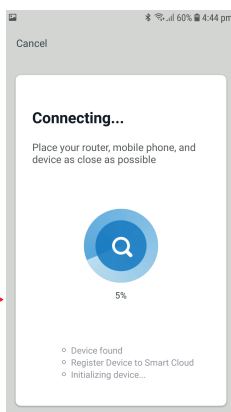
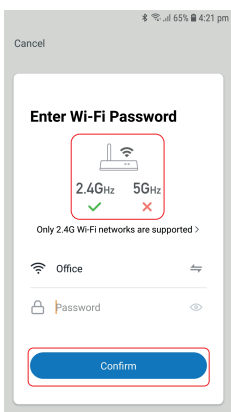
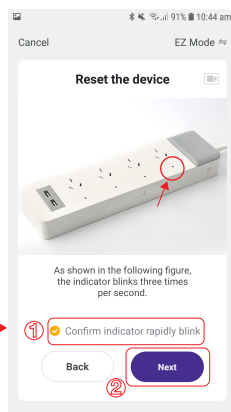
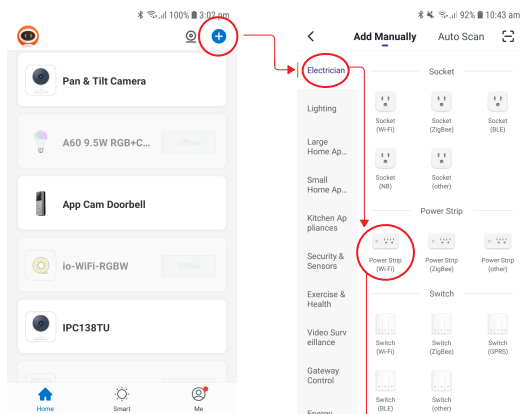

# 5 USING THE POWERBOARD

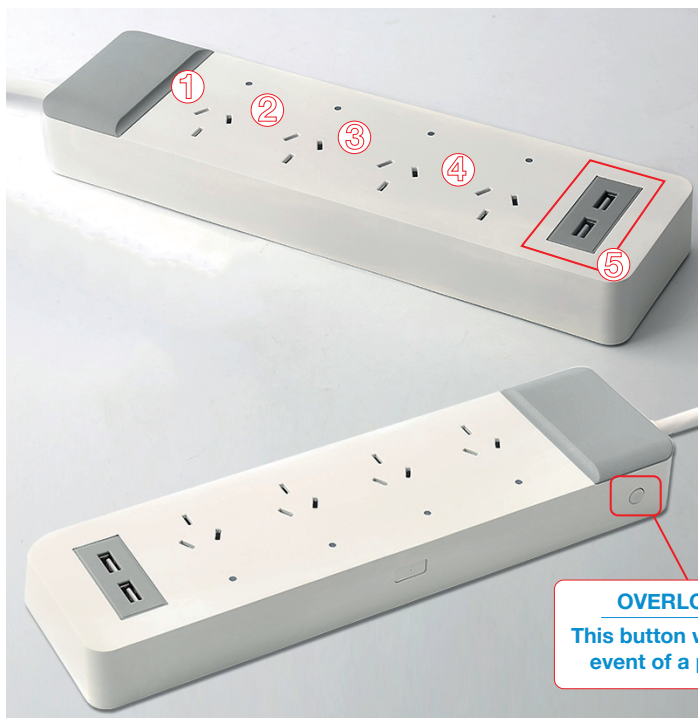
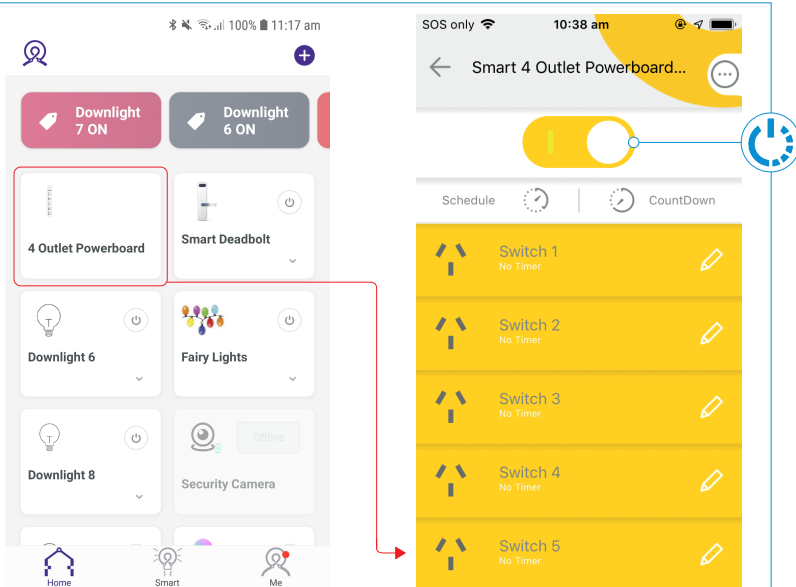

**OVERLOAD SWITCH**  
This button will pop out in the event of a power overload

# 6 | POWERBOARD SETTINGS

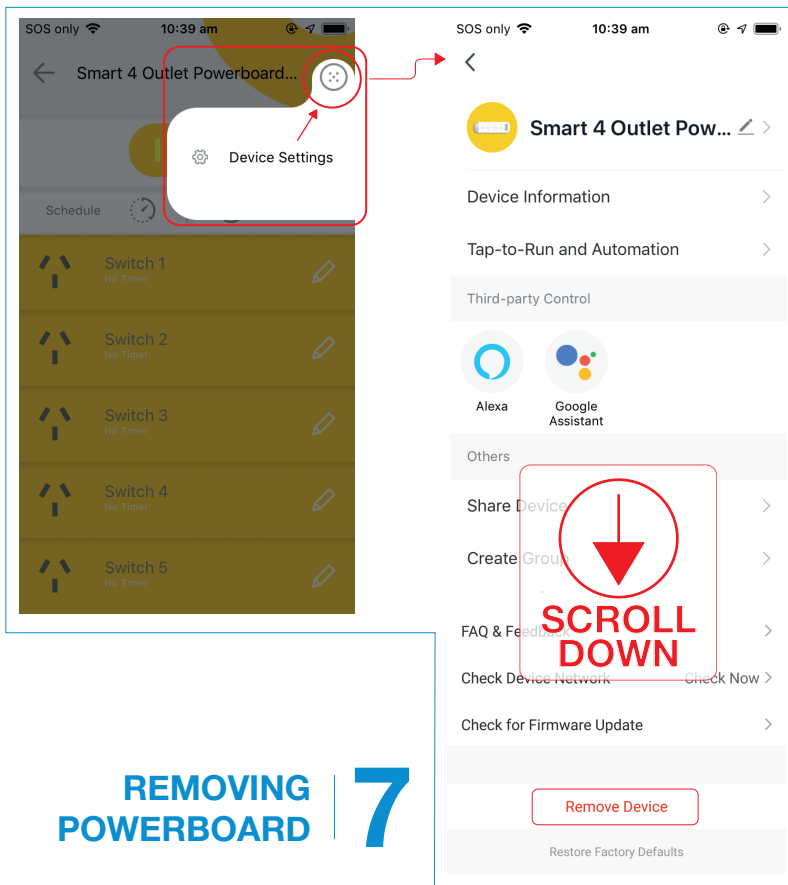

## REMOVING POWERBOARD | 7

### TROUBLESHOOTING

1. If your powerboard has trouble pairing, please check your Wi-Fi username and password are correct. Please also ensure you are using 2.4Ghz. Wi-Fi connections as 5Ghz bands are not supported.
2. If the powerboard is plugged into power but not showing any signs of life, please check the overload switch is in the out position. Please check devices connected to the powerboard as there may be an issue with a power overload or a faulty device.
3. Both USB plugs are controlled by Switch 5 in the app. There is no way to control the USB switches separately.

For more  
helpful guides  
visit us at



**LASER**  
[www.youtube.com/LasercoAu](http://www.youtube.com/LasercoAu)  
**CONNECT**  
[www.youtube.com/channel/UCCYzBiADapJN55Zzp3yfvLQ](http://www.youtube.com/channel/UCCYzBiADapJN55Zzp3yfvLQ)



### WARRANTY

Our goods come with guarantees that cannot be excluded under the Australian Consumer Law. You are entitled to a replacement or refund for a major failure and compensation for any other reasonably foreseeable loss or damage. You are also entitled to have the goods repaired or replaced if the goods fail to be of acceptable quality and the failure does not amount to a major failure.